



LT1840 18 – 40 GHz Limiter

FEATURES

- ❖ Low Insertion Loss
- ❖ 0.2" Low-profile Package Available
- ❖ Mounting Hole Option
- ❖ Custom Designs Available

SPECIFICATIONS

18 – 40 GHz Limiter	
Model Number	LT1840
Frequency Range	18 – 40 GHz
Peak Input Power	20 W Max.
CW Input Power	0.5 W Max.
Peak Flat Leakage	23 dBm Max.
CW Flat Leakage	15 dBm Max.
Insertion Loss	3.8 dB Max.
VSWR	2.2:1 Max.
Impedance	50Ω Nom.
Connector Type	2.92 mm Female
Operating Temperature	-55 °C To +85 °C

Notes

1. CW Leakage is measured at 0.5W input
2. Power handling is linearly derated from full power at 25 °C to zero at +80 °C

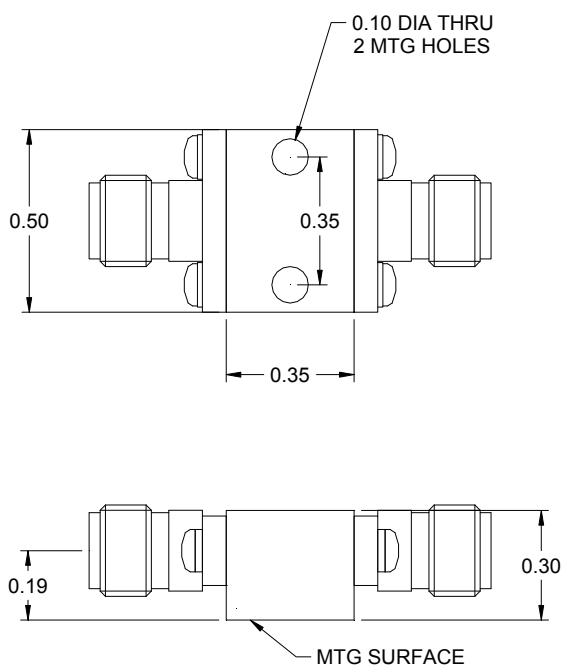



Clear Microwave, Inc

www.ClearMicrowave.com

Limiter

LT1840 18 – 40 GHz Limiter
